

# OAK PARK COMMONS

LEASING INFORMATION:  
 PARK PROPERTIES  
 11716 W. 95TH STREET  
 OVERLAND PARK, KANSAS 66214  
 (913) 492-0866

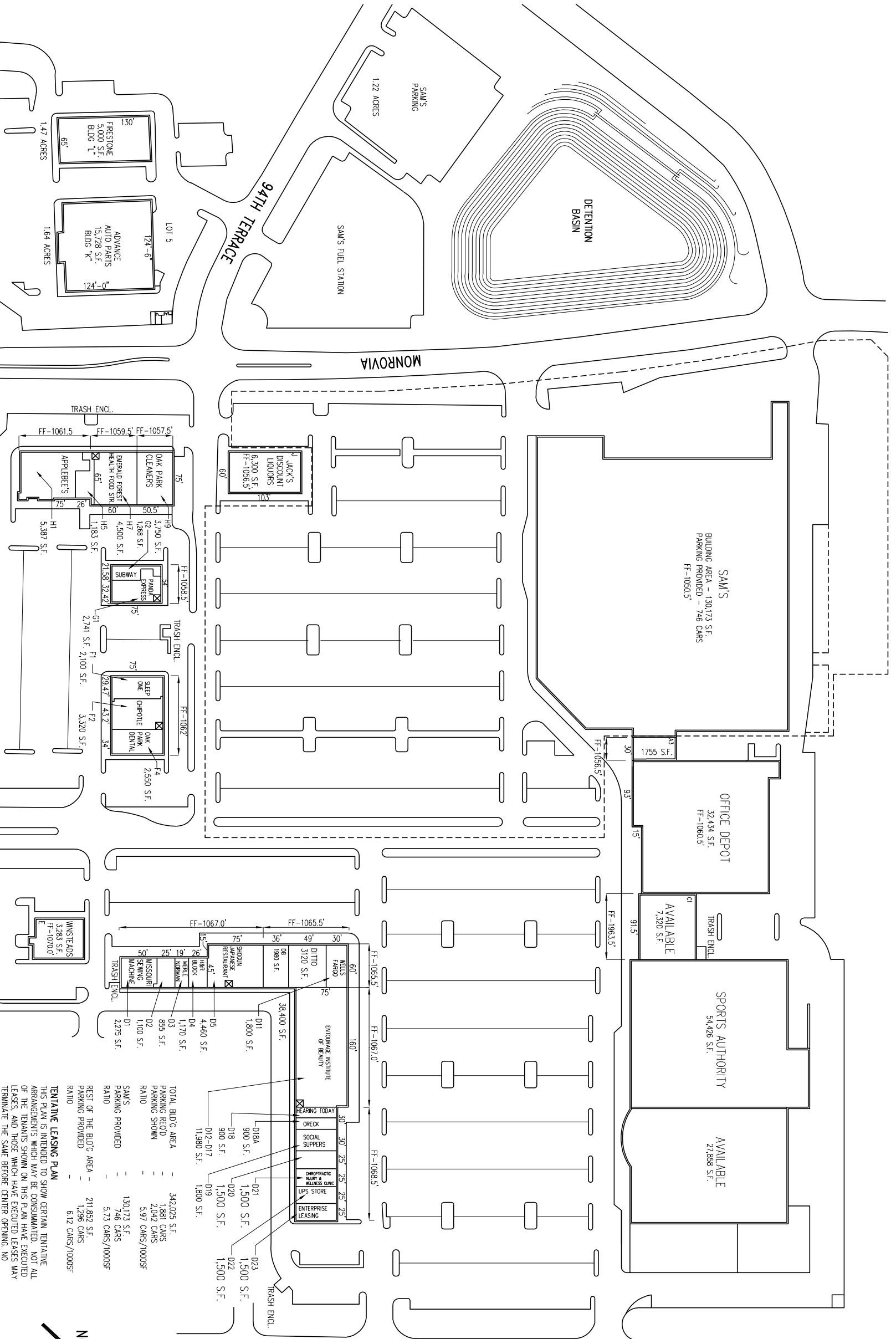

TOTAL BLDG. AREA	342,025 S.F.
PARKING RECD.	1,881 CARS
PARKING SHOWN	2,042 CARS
RATIO	5.97 CARS/1000SF
SAM'S PARKING PROVIDED	130,173 S.F.
RATIO	746 CARS
REST OF THE BLDG. AREA	211,852 S.F.
PARKING PROVIDED	1,296 CARS
RATIO	6.12 CARS/1000SF

**TENTATIVE LEASING PLAN**  
 THIS PLAN IS INTENDED TO SHOW CERTAIN TENTATIVE ARRANGEMENTS WHICH MAY BE CONSIDERED. NOT ALL OF THE TENANTS SHOWN ON THIS PLAN HAVE EXECUTED LEASES, AND THOSE WHICH HAVE EXECUTED LEASES MAY TERMINATE. THE SAME BEFORE CENTER OPENING. NO REPRESENTATION IS BEING MADE WITH RESPECT TO ANY INFORMATION SHOWN ON THIS PLAN.

LAST REVISED:  
 05.06.09



ADDRESS	LEASE SPACE
11942	D23
11944	D22
11946	D21
11948	D20
11950	D19
11952	D18a
11954	D18
12004	D12-17
12014	54,426 S.F.
12010	27,858 S.F.
12018	D11
12022	DITTO
12024	D8
12030	D5
12034	D4
12038	D3
12042	D2
12046	D1
12056	WINSTEADS
12116	C1
12124	OFFICE DEPOT
12132	A3
12148	F4
12150	F2
12154	F1
12200	SAM'S
12210	G2
12214	G1
12230	H9
12234	H7
12238	H5
12242	H1
12300	ADVANCE AUTO
12220	J
12380	L